

Tumbling Waters

*Dramatic and
luxurious—just
add mountain*



T

The pathway to this gingerbread mountain retreat winds through a landscaped garden of stones and foliage and ends at a covered stone porch supported by Craftsman-style columns. Trusses in flared gables continue the Craftsman theme and evoke a whimsical effect.

A choice of three doors off the porch leads into the mudroom, dining room, or foyer. Inside, stacked-stone pedestals support the rustic wood posts that define the dining and lodge rooms. This touch, plus hardwood floors, a stacked-stone fireplace, and towering cathedral ceilings, reinforce the feeling of a luxurious mountain resort.

PHOTO BY GET DECORATING, COURTESY OF GARRELL ASSOCIATES, INC.

ABOVE: Smart landscaping showcases the home and all of its Craftsman- and lodge-style features. The two main entries are crowned with trusses. **LEFT:** Elegant outdoor living opportunities can be found throughout the home.



ABOVE: The spacious kitchen includes such amenities as a butler's pantry, working island snack bar, a wealth of cabinetry, and stone encasements above the stove and around the blended refrigerators. **RIGHT:** The arched trusses of the cathedral ceiling highlight the lodge room and its wall of windows.



This versatile design includes practical comforts as well. The kitchen is a large, open space with few dividers, except the stone partial wall encasing the double refrigerators and an island snack bar with a sink. Stone also masks the hood above the gourmet stove and frames the stylish tile backsplash. The nearby breakfast nook is set inside a circular turret, offering radial views of the rear property and distant mountain skylines.

The master suite is a homeowner's paradise. A stepped ceiling tops the bedroom, which has its own exit to the rear deck. Enter through double doors to the master bath and experience the luxuries of a private spa: central tub, double vanities, a walk-in shower with two entries and built-in benches, even a personal breakfast bar. Two walk-in closets offer the best in wardrobe accommodations.

Across the home, two exceptional bedrooms and a full hall bath provide for family or guests. For additional guest space, the apartment is spacious enough for long-term visitors, an in-law, or an adult child.

The home's interior offers a world of



PLAN# HWD0300002

STYLE: CRAFTSMAN
TOTAL: 3,126 SQ. FT.
BONUS SPACE: 732 SQ. FT.
BEDROOMS: 3
BATHROOMS: 2½
WIDTH: 104' - 7"
DEPTH: 83' - 2"
FOUNDATION: UNFINISHED WALKOUT BASEMENT

Rustic wicker furniture decorates the iron-fenced rear deck and covered porch beyond, which includes an outdoor fireplace and built-in barbecue.

amenities, and so do the outdoor spaces. Double doors from the kitchen lead directly to a hearth-warmed screened porch. From here, exit to a secluded side deck or the covered porch that includes a second fireplace as well as a built-in grill. Beyond the overhang is the open deck, ideal for entertaining or simply enjoying the immaculate views such a desirable mountain retreat has to offer. ■

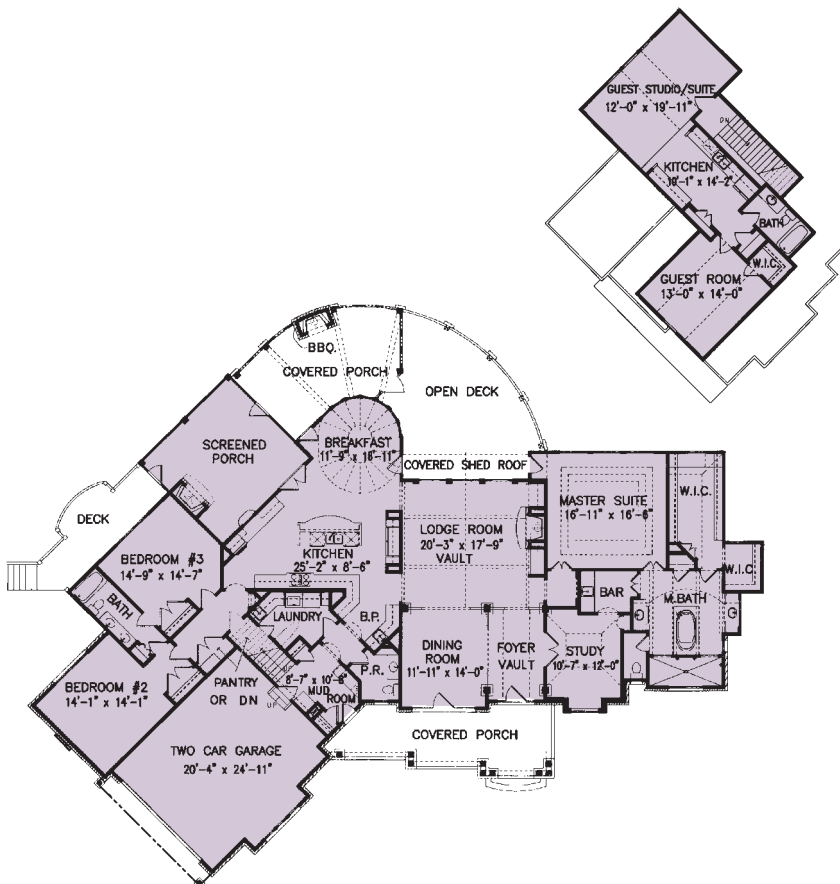

Reproducible plans are your best value.
You can make as many copies as you need!